

Windshield

Removal

CAUTION:

- Wear gloves to remove and install the windshield.
- Use seat covers to avoid damaging any surface.

- To remove the windshield, first remove the:
 - Rearview mirror (see page 20-57)
 - Sunvisors, center visor and holders (see page 20-46)
 - Front pillar trim (see page 20-45)
 - Front wipers (see section 23)

- Detach the clips from the retainers then remove both side moldings as shown.

NOTE:

- If necessary, replace any damaged clips.
- The numbers after the part names show the quantities of the parts used.

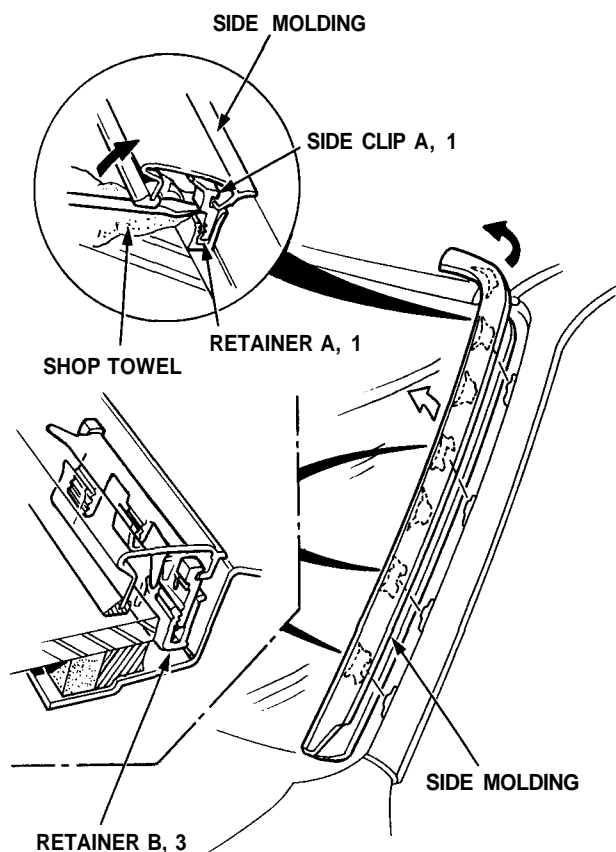

NOTE: You will need a molding clip release tool to remove some moldings. If necessary, make one that has the dimensions shown.

Molding Clip Release Tool:

Thickness: 2 mm (0.08 in), pointed at the end.

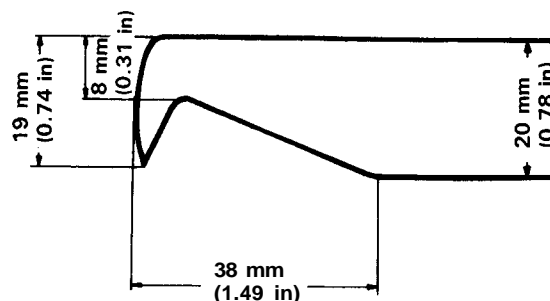

- Detach the upper molding with a molding clip release tool.
- Detach the clips, then remove the upper molding.

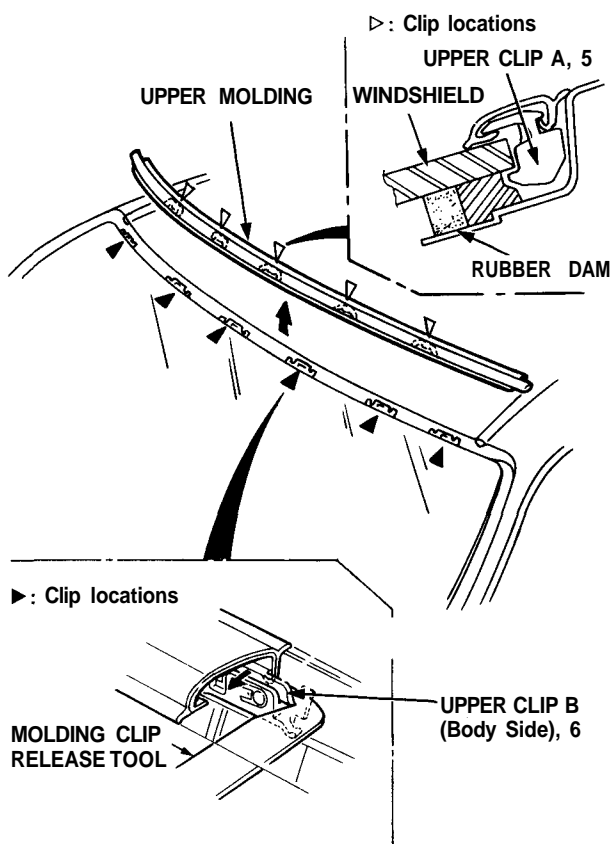

- Remove the other clips and retainers from the body.



6. Remove the lower molding and remove the lower clips from the body.

NOTE: The numbers after the part names show the quantities of the parts used.

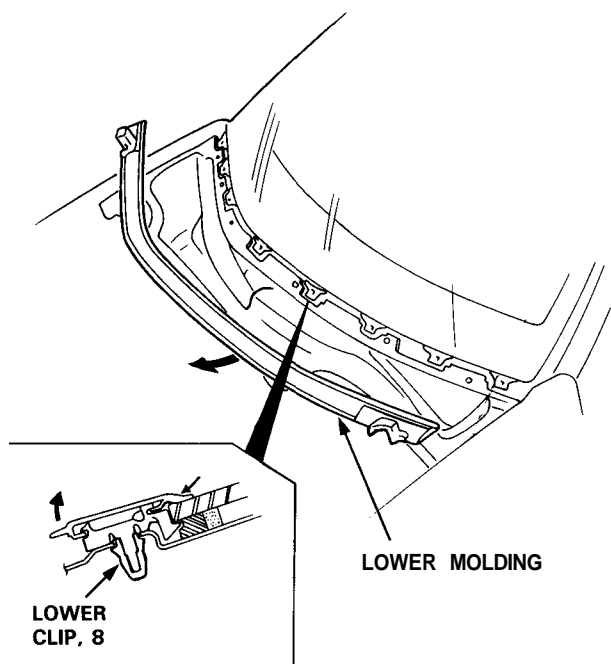

7. Pull down the front of headliner (see page 20-46).

CAUTION: Take care not to bend the headliner excessively.

8. Apply protective tape to the edge of the dashboard and body as shown.

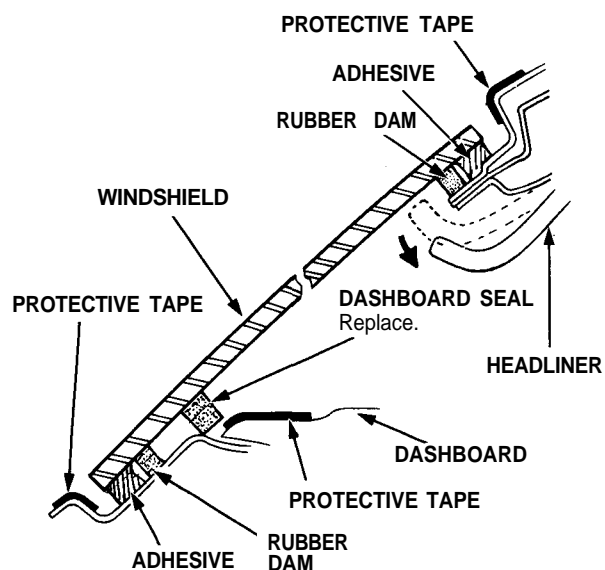

9. Using an awl, make a hole through the rubber dam and adhesive from inside the car. Push the piano wire through the hole and wrap each end around a piece of wood.

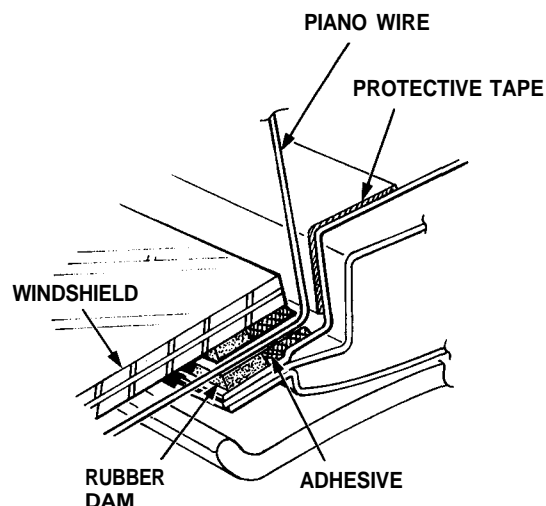

10. With a helper on the outside, pull the piano wire back and forth in a sawing motion and carefully cut through the adhesive around the entire windshield, then carefully remove the windshield.

CAUTION: Hold the piano wire as close to the windshield as possible to prevent damage to the body and dashboard.

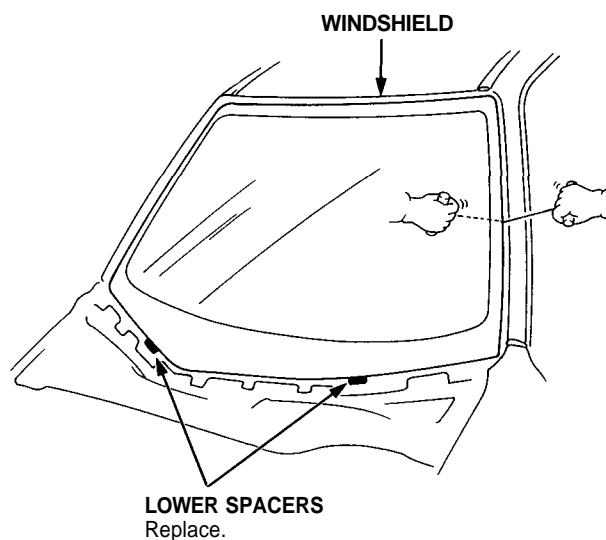

11. Cut the lower spacers away from the body with a knife; they are cemented in place.

NOTE: Replace the lower spacers with new ones whenever the windshield is removed.